

1

AREA OF APPLICATION

2

SUBSTRATES

3

INSTALLATION

4

FIRST USE

5

MAINTENANCE/
GUARANTEE

IMPORTANT

This floor covering is reserved for residential use and small commercial premises only (offices, small shops, etc.) and cannot be used in the following cases: conservatories or verandas, areas where temperatures may fall below 15°C, reversible floor heating or with temperatures exceeding 28°C, cracked floors, rising damp from the floor, and OSB boards.

In excessive heat, you are advised to obscure your bay window/skylight to prevent the product from expanding.

The use of underlay is not recommended.

For any additional technical information, please consult a specialist.

IMPORTANT: The information in this document is valid from 2021, March 17th and is subject to change without notice. We are continuously making technical improvements to our products; before starting any work, our customers should check with us that this document is still in force.

[020_{v1}]
SENSO EASY
PREMIUM

1

2

3

4

5

AREA OF APPLICATION

SUBSTRATES

INSTALLATION

FIRST USE

MAINTENANCE/
GUARANTEE

1. GENERAL

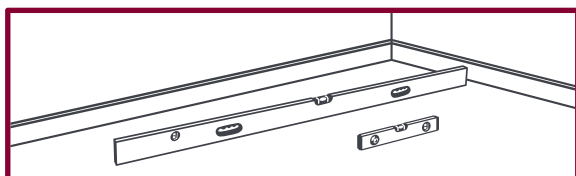

The flooring must be laid on a flat, clean, sound, dry and solid substrate.



The substrate must be dry and must not have any risk of rising damp. Do a control test if necessary.

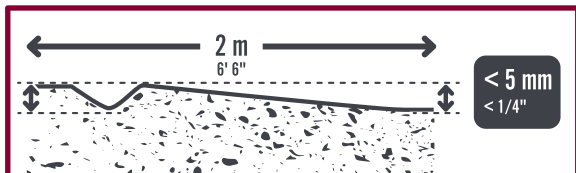

The evenness must be < 5 mm under a 2-metre straight edge.

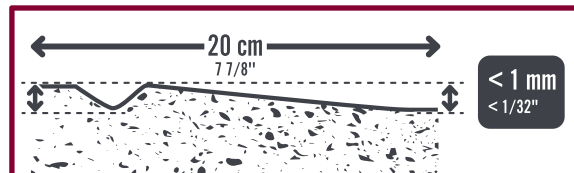

The substrate must not have any uneven areas > 1 mm every 20 cm.

2. RECOMMENDATIONS BY TYPE OF SUBSTRATE

Substrate

Conditions

Ceramic tiles	✓	If grout joints are less than 4 mm wide and less than 1 mm deep. Otherwise, apply a levelling compound to prevent the grout lines from showing through (known as telegraphing). Sand and apply a primer.
Carpet/Laminate floor	✗	Remove the floor covering and if the floor has many irregularities, apply a patching compound.
OSB floor	✗	Securely fix plywood over the existing OSB.
Underlayer	✗	Remove the underlay. If the floor has too many irregularities, apply a patching compound.
Underfloor heating with circulating hot water	✓	28°C Max.
Radiant electric and reversible underfloor heatings	✗	-
Compact vinyl floor/soundproof floor/laminated parquet	✗	Remove the floor covering and any underlayer. If necessary, apply a levelling compound.
Concrete floor, painted concrete, levelling concrete, liquid cement screed	✓	If the moisture content < 4 %, without cracks. If the floor has too many irregularities, apply a patching compound.
Anhydrite screed	✓	If moisture content < 0.5%. Remove surface laitance and apply a primer for anhydrite screed.
Wood strip flooring and timber panels	✓	Glued wood strip flooring: remove. Flooring on joists : securely fix plywood over the existing panels.

[020_{v1}]
SENSO EASY
 PREMIUM

1

2

3

4

5

AREA OF APPLICATION

SUBSTRATES

INSTALLATION

FIRST USE

MAINTENANCE/
GUARANTEE

1. BEFORE LAYING

All floor coverings should be examined prior to installation for any visible defects.

To ensure colour uniformity, the floor covering laid in any one room should be from the same manufacturing batch, marked on the packaging.

The room temperature during installation must be between 15°C and 26°C.

The planks or tiles must be unpacked, design side up, in the room 24h before installation.

Clean the surface before laying.



2. TOOLS



Utility knife



Tape measure

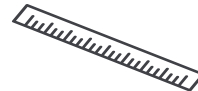

Metal rule



Cut-resistant gloves

3. LAYING DIRECTION

The planks/tiles must be oriented towards the wall with the main window, or lengthwise.

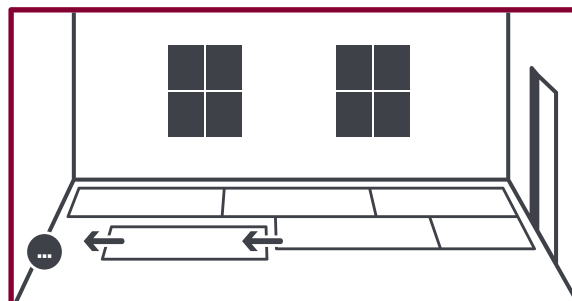

[020_{v1}]
SENSO EASY
PREMIUM

1	2	3	4	5
AREA OF APPLICATION	SUBSTRATES	INSTALLATION	FIRST USE	MAINTENANCE/ GUARANTEE

4. LAYOUT OUT THE GUIDELINES

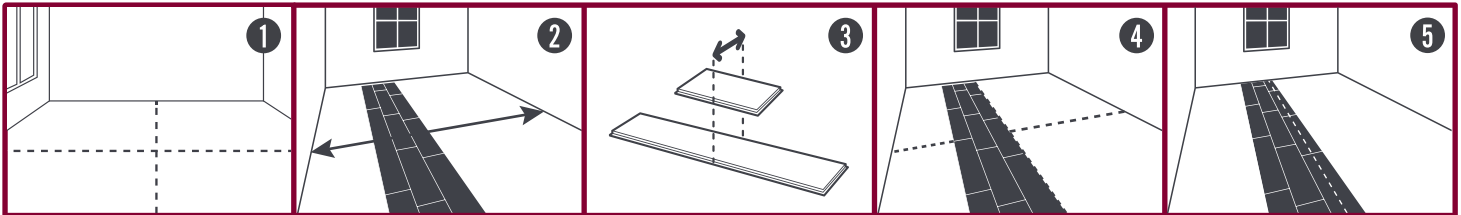

- 1 Divide the room into 4 parts by drawing 2 perpendicular lines intersecting in the centre of the room.
- 2 Measure the side of the room perpendicular to the installation.
- 3 Divide this measurement by the width of the plank/tile. Round up to the next whole number.
- 4 If the number is even, start installation with one plank/tile at either side of the centre line.
- 5 If the number is uneven, start installation with one plank/tile straddling the centre line.

5. PRIMER APPLICATION

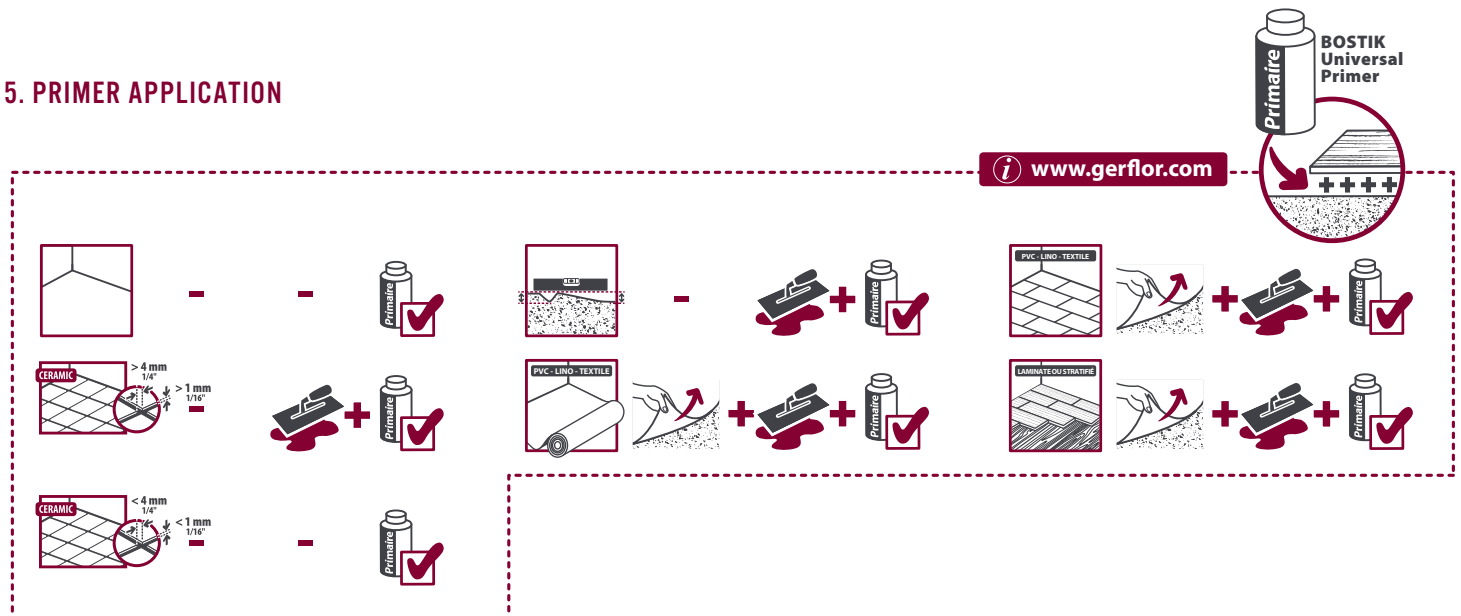

1

2

3

4

5

AREA OF APPLICATION

SUBSTRATES

INSTALLATION

FIRST USE

MAINTENANCE/
GUARANTEE

6. INSTALLATION

A/ Laying the planks

- Install the planks on a clean surface.
- Start installing along the longitudinal line.
- Pull off the protective paper.
- Press the plank firmly from the centre outwards.

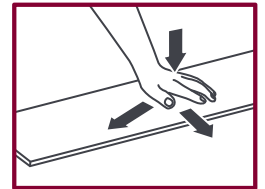
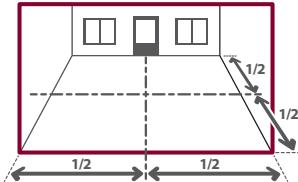

Planks must be offset by at least 25 cm, ideally one third of the plank.

A maximum edge clearance of 1 to 2 mm should be left around the edge of the room and around fixed objects.

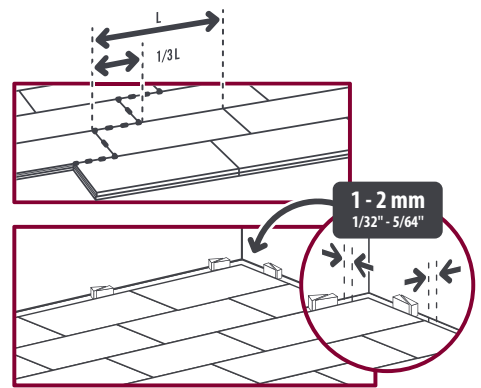

B/ Laying the tiles

- Install the tiles on a clean surface.

Square format

- Start against one of the right angles formed by the intersection of the 2 lines in the centre of the room.
- Check the tile joints for evenness.

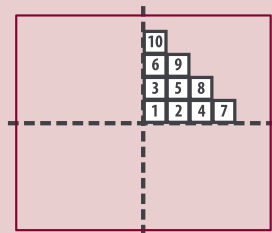

Square tiles can also be laid with staggered joints.

- Pull off the protective paper.
- Press the tile firmly from the centre outwards.

A maximum edge clearance of 1 to 2 mm should be left around the edge of the room and around fixed objects.

Rectangular format

- Lay down the tiles in staggered joint along the guidelines on the floor.
- Check the tile joints for evenness.

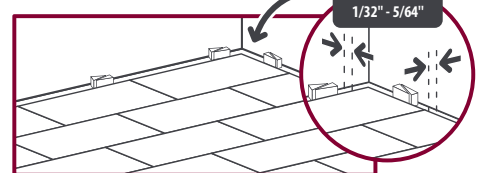
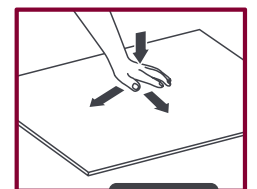
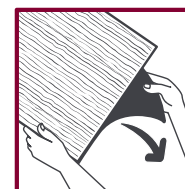
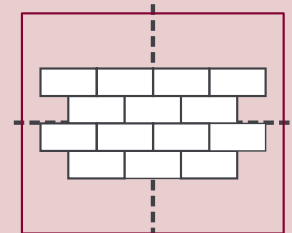

[020_{v1}]
SENSO EASY
PREMIUM

1

AREA OF APPLICATION

2

SUBSTRATES

3

INSTALLATION

4

FIRST USE

5

MAINTENANCE/
GUARANTEE

7. CUTTING

For the tiles, even out the cuts on the edges. Cuts are made using a utility knife:

- With a straight blade, make one or more cuts along the surface of the plank.
- Bend the plank/tile to snap it.

When installed in bathrooms and toilets, we recommend the use of a PU or MS Polymer mastic around the perimeter of the room, fixtures and pipes.

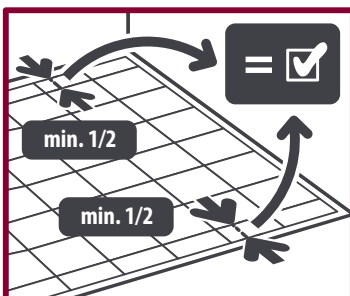
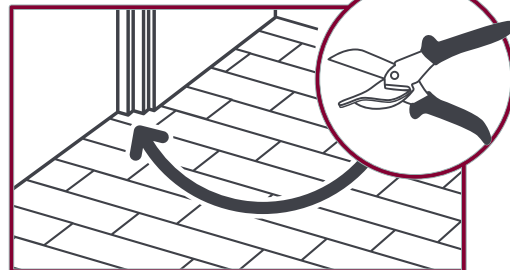
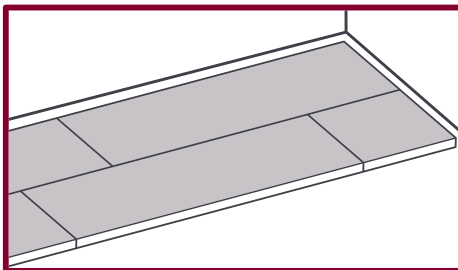
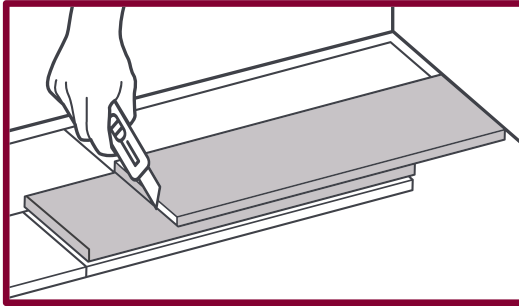

TIP: For cutting around door frame bases and areas which are difficult to access, use gripper shears.

[020_{v1}]
SENSO EASY
PREMIUM

1

AREA OF APPLICATION

2

SUBSTRATES

3

INSTALLATION

4

FIRST USE

5

MAINTENANCE/
GUARANTEE

The flooring can be used **immediately** after laying.

Precautions for use: Place plastic or felt pads under furniture legs or heavy objects. Protect tiles/planks from heat sources and possible blasts of heat. Do not use rubber end caps (tables, chairs, sofas, etc.), as well as rubber-backed entrance mats.

Use felt caps.

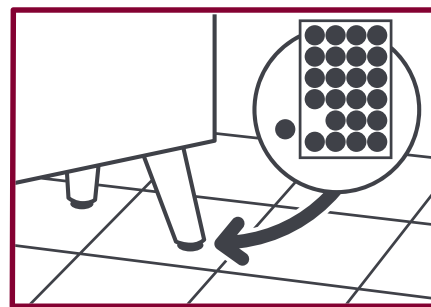
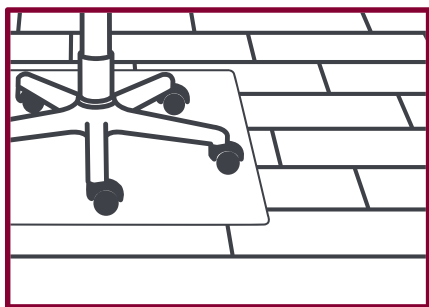

1	2	3	4	5
AREA OF APPLICATION	SUBSTRATES	INSTALLATION	FIRST USE	MAINTENANCE/ GUARANTEE

Cleaning your floor: vacuum cleaner or damp mop. Regular non-abrasive detergent.

Tough stains: diluted liquid bleach, white spirit, ethyl alcohol, or lemon juice.

Stubborn stains (ink, tomato, mustard, blood, beets, Mercurochrome): let diluted liquid bleach sit for several minutes, without rubbing. Rinse thoroughly.
Rust: clean using a textile rust remover. Rinse thoroughly.

Grease, pen, felt pen: rub lightly with a cloth soaked in white spirit. Rinse thoroughly.

Maintenance precautions: do not use acetone or chlorinated solvents (e.g. trichloroethylene). Never use waxes or vitrifying varnish.

The Gerflor commercial warranty for domestic products is available at www.gerflor.com

Replacing a plank/tile:

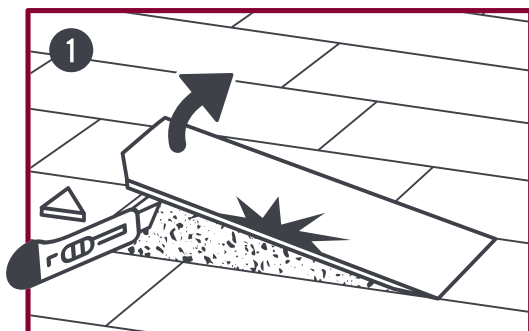

Cut into the corner using the utility knife.
 Remove the plank/tile.

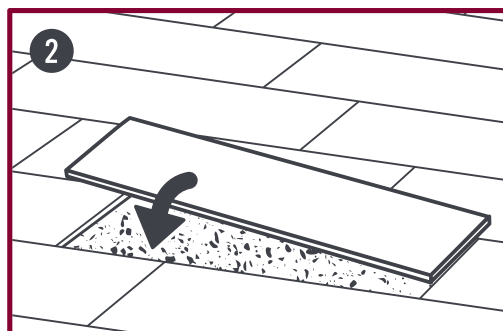

Then reposition a plank/tile and firmly press the plank from the centre outwards.

ADDITIONAL INFORMATION:

The joints between tiles/planks may separate – this is part of natural ageing and does not need to be repaired.